

Over Pressure Protector PN 400 / PN 600 DN 3 for pressure gauges

CONFIGURATIONS AND DIMENSIONAL DATA

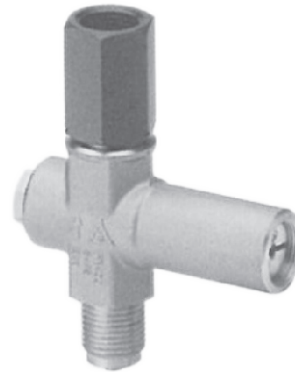
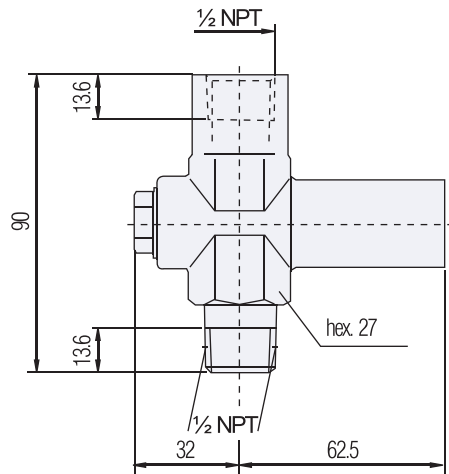

Gauge Protector PN 400 / PN 600
male/female : 1/2" NPT

			Adjusting range in bar						
			0,4 - 2,5	2 - 6	5 - 25	20 - 60	50 - 250	240 - 400	400 - 600
Type	Connection	Material	Part No.						
1	1/2 NPT	brass	S005.50.021	S005.50.022	S005.50.023	S005.50.024	S005.50.025	-	-
		st. st. 316	S005.50.221	S005.50.222	S005.50.223	S005.50.224	S005.50.225	S005.50.226	-
2	G 1/2	brass	S005.50.001	S005.50.002	S005.50.003	S005.50.004	S005.50.005	S005.50.006	S005.50.007
		st. st. 316	S005.50.201	S005.50.202	S005.50.203	S005.50.204	S005.50.205	S005.50.206	S005.50.207

D V G W - Registration (only for type 2 up to 400 bar)

DVGW-Register-No. DG-4515AO0762

The part numbers for types with DVGW-registration
have to be complete with **.00DV**
(e. g. adjusting range 240 - 400 bar S005.50.206.**.00DV**).

Material	Max. overpressure	Low pressure range
brass	600 bar	max. load up to - 1 bar, not adjustable
stainless steel	1000 bar	

Components	Brass	Stainless steel
	DIN - Material Number	
Body	brass	SS 316
Piston	SS 316	
Adjusting nut	steel	SS 316
Packing	FPM (Viton®)	
Screw plug	brass	SS 316

- **Body:** brass: pressed part
stainless steel: die-pressed part

- **Application:**

Gauge protectors close at a set point protecting gauges from overrange pressures.

- **Function:**

By reaching the adjusted pressure, the valve closes automatically and blocks the flow to the pressure instrument. After decrease of pressure by about 25 % below the closing pressure, the valve opens again.

- **Max. temperature:** 80°C
(60°C for type
S005.50.001.00DV / 201.00DV)

- 1) Available with inspection certificate 3.1.B acc. to EN 10 204
- 2) Can also be supplied for oxygen application, free of oil and lubricant (Please notice order instruction B 3!)
- 3) Other connection types on request
- 4) DVGW-type made of brass

Pressure Gauges Valve male / female : 1/2" NPT

CONFIGURATIONS AND DIMENSIONAL DATA

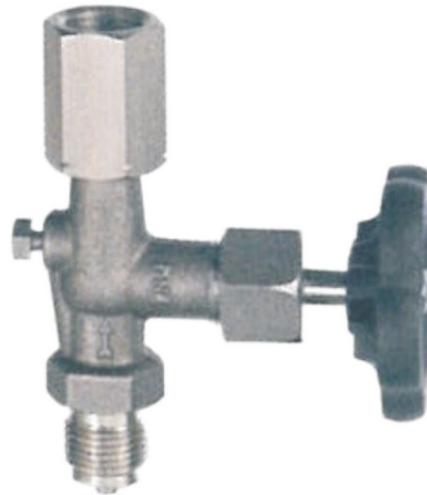
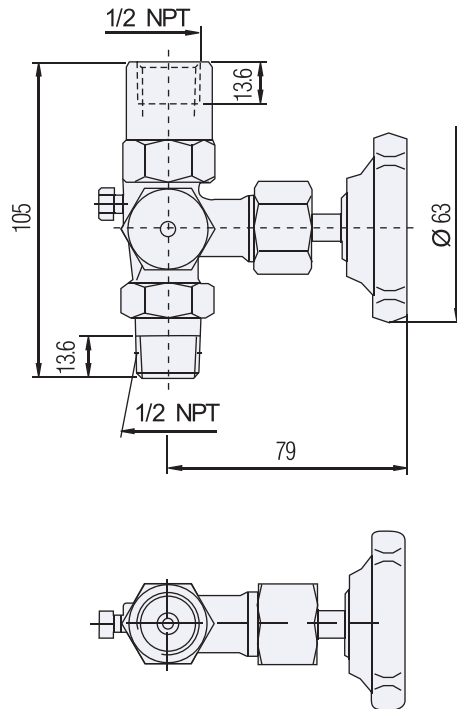

PRESSURE GAUGES VALVE PN 400
MALE/FEMALE : 1/2" NPT

MOUNTING ACCESSORIES

PN	Connection thread d	Material	Part no.
400	1/2 NPT	steel st. st. 316	S004.16.183 S004.16.283

Components	Steel	Stainless steel
	DIN - Material Number	
Body	1.0460	SS 316
Valve stem	1.4104	SS 316
Needle tip	1.4104	SS 316
Packing	PTFE up to 200°C	
Union nut	steel	stainless steel
Vent screw	SS 316	
Handwheel	plastic	

- Body: die-pressed part
 - Surface: steel phosphatized
 - internal stem thread
 - Stem with cold rolled surface and non-rotating needle tip
 - Valves with alternative test connections optional
- 1) Can also be supplied for oxygen service. Please notice order instruction B 3!
 - 2) Available with inspection certificate 3.1.B acc. EN 10 204
 - 3) With protecting cap and sealing lense

Needle Valve PN 420 DN 5 female / female and male / female

CONFIGURATIONS AND DIMENSIONAL DATA

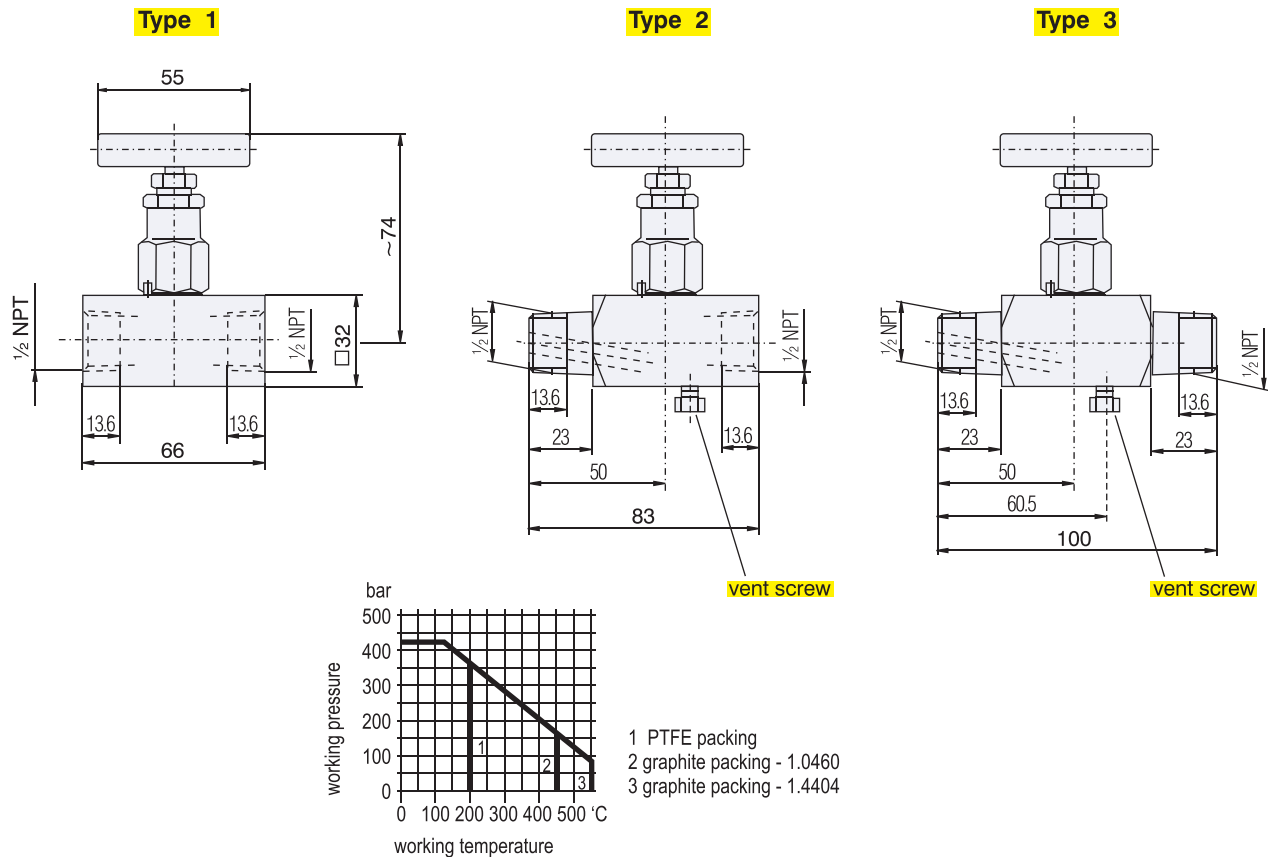

Type	Material	Connections		Remarks	Part No.
		Inlet	Outlet		
1	steel st. st. 316	1/ 2 NPT female		without vent screw	N354.03.101.05 N354.03.401.05
2	steel st. st. 316	1/ 2 NPT male	1/ 2 NPT female		N354.07.101.05 N354.07.401.05
	steel st. st. 316			N354.16.101.05 N354.16.401.05	
3	steel	1/ 2 NPT male		with vent screw	N354.02.402.05

Components	Steel	Stainless steel
	DIN - Material Number	
Body	1.0460	316L
Bonnet	316	
Valve stem	316 L	
Needle tip	1.4122	316
Packing	PTFE up to 200 °C (graphite up to 550 °C)	
Gland nut	1.4301	
T-handle	stainless steel	

- Surface: steel phosphatized
- For max. working pressure 700 bar (10.000 psi):
Part no. N 354.03.101.85 replaces N 354.03.101.05

- External stem thread
- Stem with cold rolled surface, back seat and non-rotating needle tip
- Type with 1/4 NPT thread on request
- The valves can be supplied according to NACE-standard

On request:

- Anti-tamper facility
- Panel mounting
- Extended body on male inlet port
- Padlocking facility

Block and Bleed Valve PN 420 DN 5 female / female and male / female

CONFIGURATIONS AND DIMENSIONAL DATA

Type 1

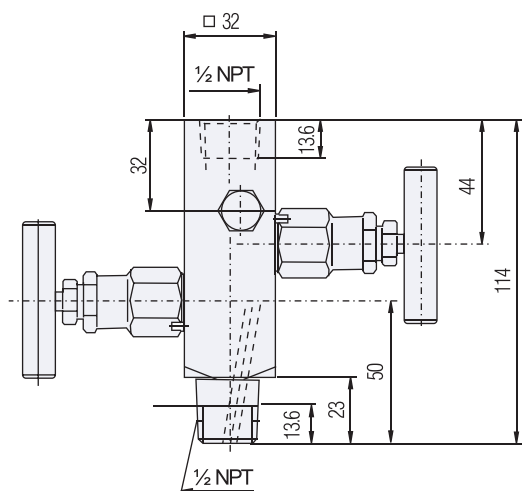

Type 2

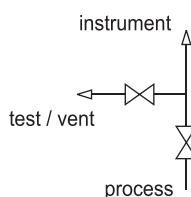
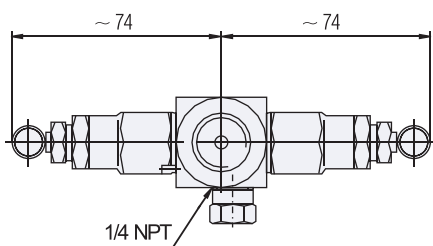
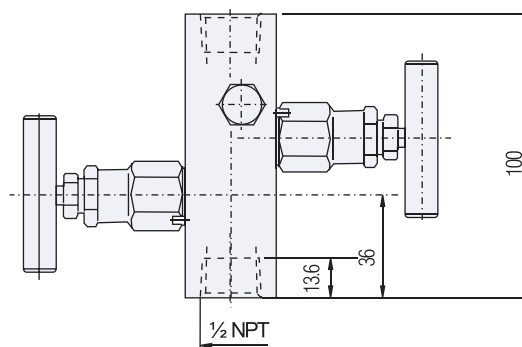

- 1 PTFE packing
- 2 graphite packing - 1.0460
- 3 graphite packing - 1.4404

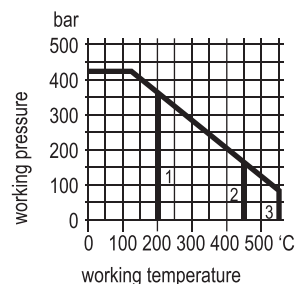

Type	Material	Inlet	Connections		Part no.
			Outlet	Test / Vent	
1	steel st. st. 316	1/ 2 NPT male	1/ 2 NPT female	1/ 4 NPT female with screw plug	N354.60.101.05 N354.60.401.05
2	steel st. st. 316	1/ 2 NPT female			N354.60.109.05 N354.60.409.05

Components	Steel	Stainless steel
	DIN - Material Number	
Body	1.0460	316L
Bonnet	316	
Valve stem	316	
Needle tip	1.4122	316
Packing	PTFE up to 200 °C (graphite up to 550 °C)	
Gland nut	1.4301	
T-handle	stainless steel	

- Surface: steel phosphatized
- Working pressure up to 700 bar (10.000 psi) on request
- External stem thread
- Stem with cold rolled surface, back seat and non-rotating needle tip
- The valves can be supplied according to **NACE-standard**
- On request:
 - Anti-tamper facility
 - Panel mounting
 - Extended body on male inlet port
 - Padlocking facility

CONFIGURATIONS AND DIMENSIONAL DATA

Type 1

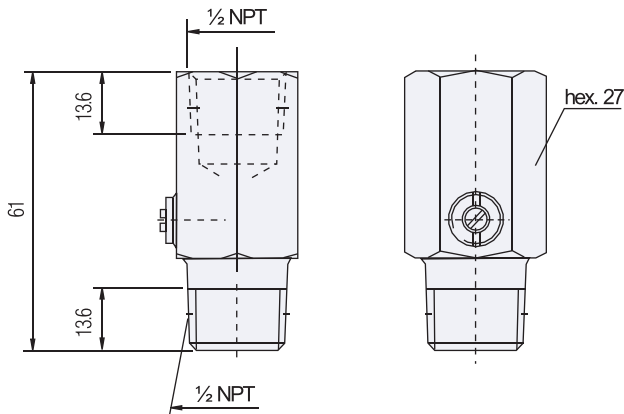

Type 2

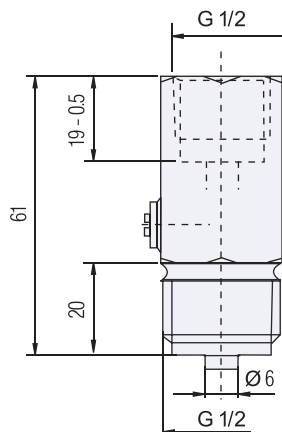
Gauge Snubber PN 400
male/female : 1/2" NPT

Type	Material	Connection thread	Part no.
1	brass st. st. 316	1/2 NPT	S005.10.010 S005.10.210
2	brass steel st. st. 316	G 1/2	S005.10.000 S005.10.100 S005.10.200

Components	Brass	Steel	Stainless steel
	DIN - Material Number		
Body	brass	steel	SS 316
Screw plug	brass	steel	SS 316
O-ring	NBR		FPM (Viton®)
Adjusting stem	SS 316		

- Surface: steel phosphatized- Max. temperature: 120°C

1) Also available with connection thread G 1/4, G 3/8 and 1/4 NPT

2) The brass and stainless steel types can be supplied for oxygen service.
Please notice order instruction B 3!
max. 400 bar at 60°C

Water Syphon and Cooling Elements for Pressure Gauges

Water Syphon circular-shaped ('pigtail') for vertical tapping

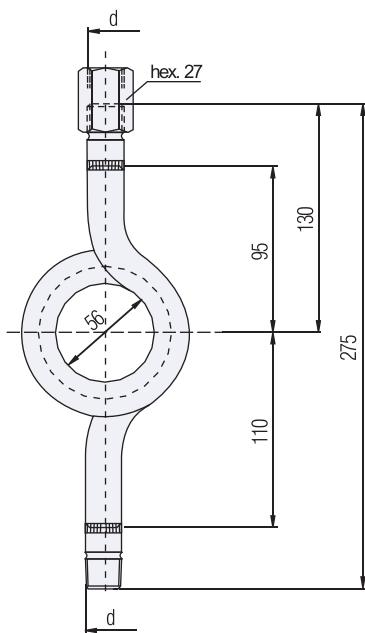

Connection thread	Material	Part no.
1/2" NPT	steel st. st. 316	S006.08.100 S006.08.200

Cooling Elements

APPLICATION

Cooling elements are applied to decouple the pressure measuring instrument from the measuring point. This is strongly recommended for medium temperature of +100°C and up. Versions for temperature up to +250°C are available.

STANDARD CONFIGURATION

MATERIAL

Stainless steel 316 L

INSTRUMENT CONNECTION

1/2" NPT female

LENGTH

Model KEI : 100 mm

Model KEH : 78 mm

for medium temperature up to 150°C

PRESSURE LIMIT

PN 400 bar

SPECIAL OPTIONS

Model KEI : lenght 200 mm for medium temperature up to 250°C

We recommend the usage a capillary line for temperature > + 250°C, resp. lenght > +200 mm

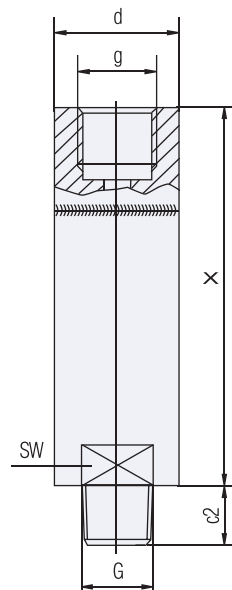

Model KEI

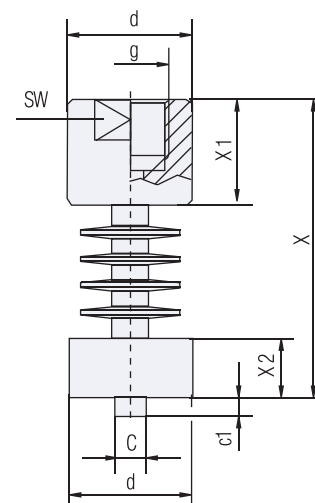

Model KEH

Dimensional Data (mm) and Weight (kg)

Model	c	c1	c2	d	g	G	x	x1	x2	SW	Weight (approx.)
KEI	6	3	20	33	1/2" NPT	1/2" NPT	100**	—	—	27	0.40
KEH	8	5	—				78	36	10		0.35

** optionally 200 mm for temperatures > =150°C (up to +250°C max.)